

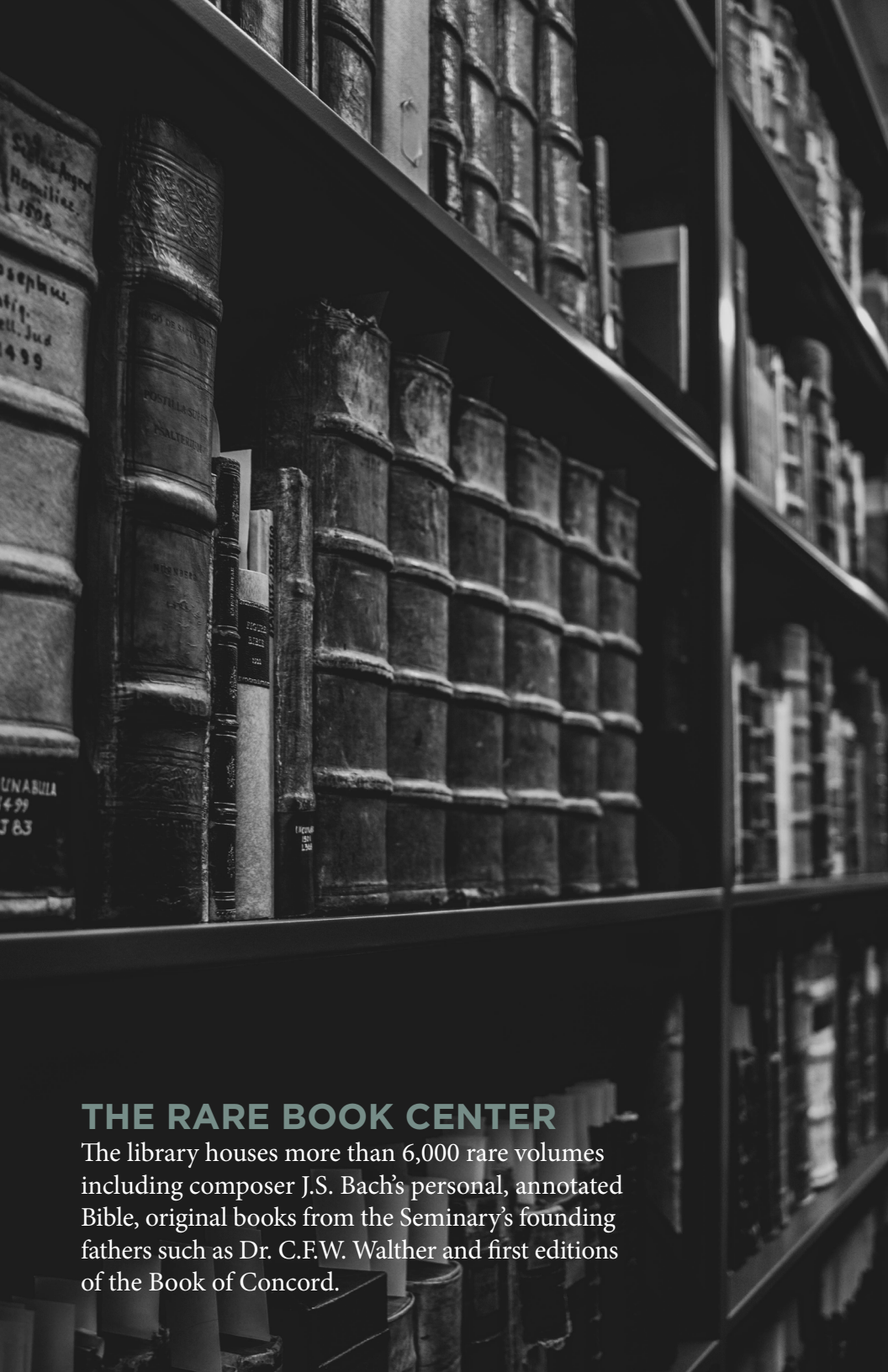

KRISTINE KAY HASSE MEMORIAL LIBRARY
GRAND OPENING



THE RARE BOOK CENTER

The library houses more than 6,000 rare volumes including composer J.S. Bach's personal, annotated Bible, original books from the Seminary's founding fathers such as Dr. C.F.W. Walther and first editions of the Book of Concord.

KRISTINE KAY HASSE MEMORIAL LIBRARY GRAND OPENING

Friday, Aug. 24, 2018

Welcome & Introductions

Rev. Dr. Dale A. Meyer ('73), Seminary President

Remarks

The Honorable Harold Sanger, Mayor, City of Clayton

Andrew Hatesohl, S.T.M. candidate ('19)

Glenn and Kay Hasse, Friends of Concordia Seminary

Rev. Benjamin Haupt ('05, '11), Director of Library Services

Lecture

Rev. Dr. Robert Rosin ('76), Professor Emeritus of Historical Theology

Rosin served as a faculty member from 1981 until his retirement in 2016 as the Eugene E. and Nell S. Fincke Graduate Professor of Theology. He served as editor of Concordia Seminary publications (1995–2005) and chairman of the Department of Historical Theology (1995–2004). He also served as the director of library services (1988–90), as the director of the Center for Reformation Research (1997–2013), as coordinator for theological education in Eurasia for The Lutheran Church—Missouri Synod (2004–2015) and as a frequent guest instructor or lecturer abroad.

He received his Ph.D. and M.A. from Stanford University in Palo Alto, Calif. (1986, 1977); M.Div. from Concordia Seminary (1976); and B.A. from Concordia Teachers College in River Forest, Ill., now Concordia University Chicago (1972). He has published widely on Reformation-era history and theology.

Closing Remarks

Rev. Benjamin Haupt

Following the closing remarks, please proceed to the Kristine Kay Hasse Memorial Library north entrance for the Rite of Blessing and ribbon-cutting.

Invocation & Rite of Blessing

Rev. Dr. Dale A. Meyer

Prayers

Rev. Dr. Michael Coppersmith ('80)

Benediction & Ribbon Cutting

Rev. Dr. Dale A. Meyer

Following these festivities, please join us for a reception and time to explore the library.



LOWER LEVEL

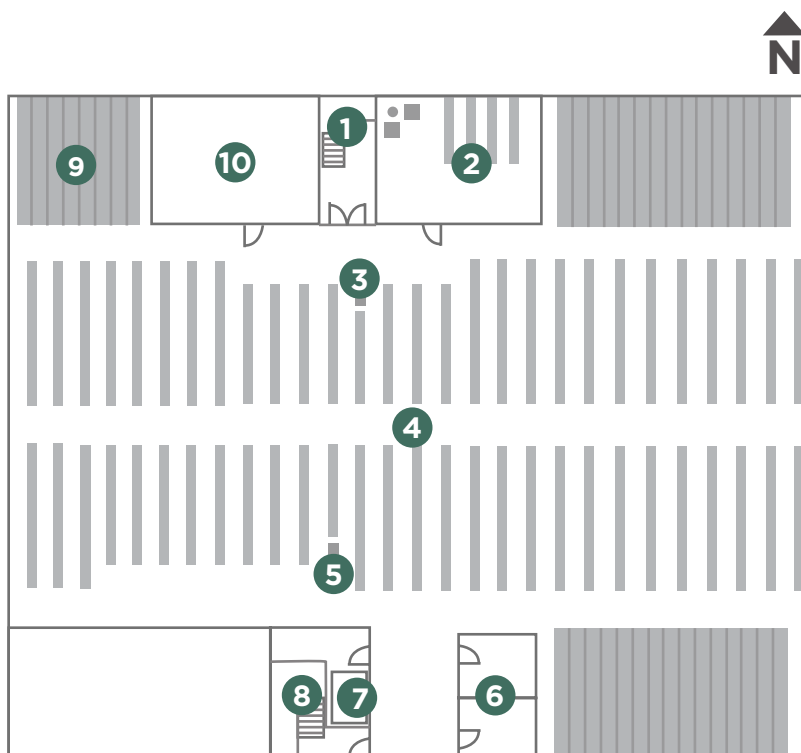

- | | |
|------------------------------------|----------------------------------|
| 1 North stairway | 6 Restrooms |
| 2 Center for Hispanic Studies room | 7 Elevator |
| 3 Catalog area | 8 South stairway |
| 4 Main stacks | 9 Oversized, books, DVDs and CDs |
| 5 Catalog area | 10 Collaborative study center |



LEVEL ONE

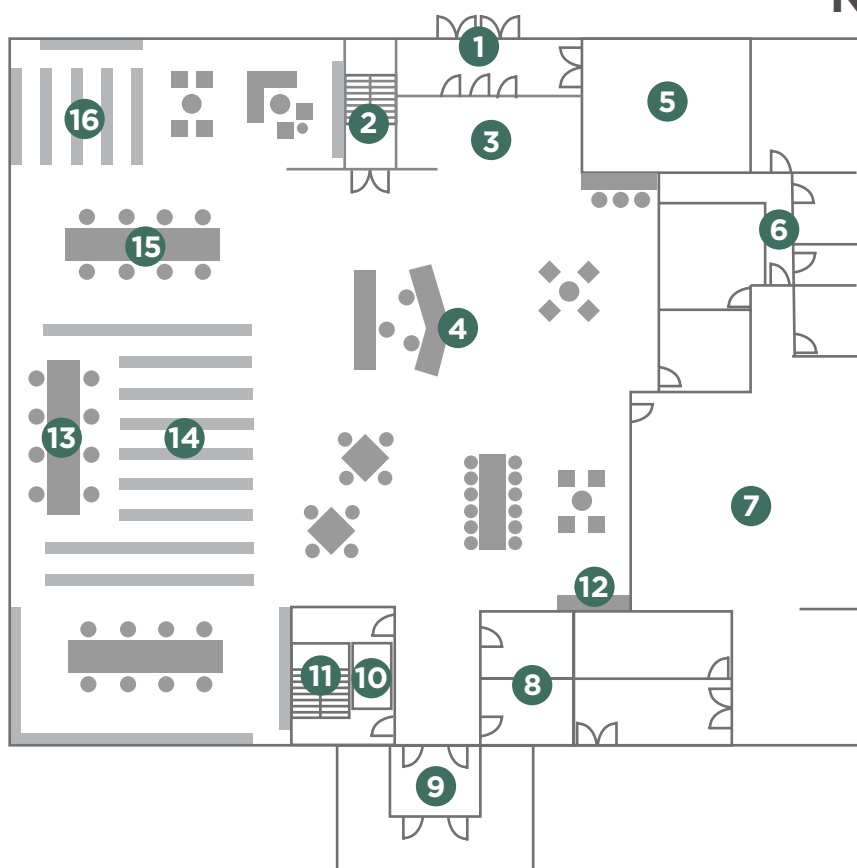

- | | |
|----------------------|-------------------------------|
| 1 North entrance | 9 South entrance |
| 2 North stairway | 10 Elevator |
| 3 Lobby | 11 South stairway |
| 4 Circulation center | 12 Coffee bar |
| 5 Conference room | 13 M.Div. study center |
| 6 Office suite | 14 Reference collection |
| 7 Staff work center | 15 Public computers |
| 8 Restrooms | 16 Current periodicals lounge |



LEVEL TWO

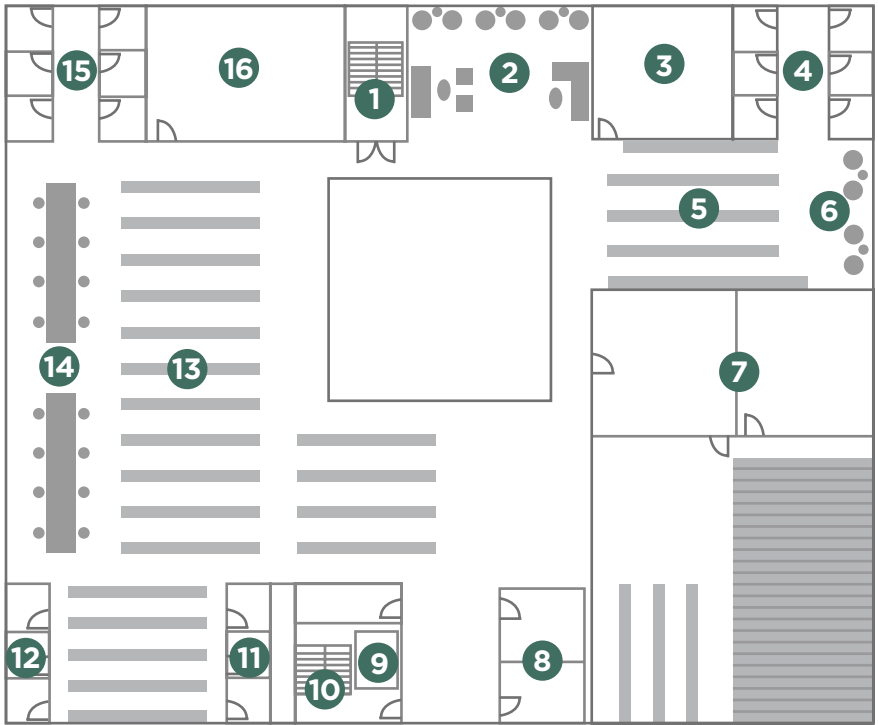

① North stairway

② Reading room

③ Classroom

④ Ph.D. private study rooms

⑤ Bibliographic reference

⑥ Quiet study

⑦ Rare Book Center

⑧ Restrooms

⑨ Elevator

⑩ South stairway

⑪ Ph.D. private study rooms

⑫ Ph.D. private study rooms

⑬ Bound periodicals

⑭ Graduate studies center

⑮ Ph.D. private study rooms

⑯ Classroom



NEW CLASSROOMS

The library now features three classrooms with state-of-the-art audiovisual capabilities, improved lighting and new furniture, conducive to a dynamic, collaborative learning environment.



LIGHT FROM ABOVE

The centerpiece of the library renovation is the new pyramid-shaped skylight over the building's central atrium that enables natural light to illuminate the spaces below.



WITH GRATEFUL APPRECIATION

Concordia Seminary, St. Louis is deeply grateful to Glenn and Kay Hasse of Naples, Fla., for their generous support of the renovation of the Kristine Kay Hasse Memorial Library. The Hasses are passionate in their support for students being formed to bring Jesus Christ to their congregations, communities and world. “There’s no greater gift that we can give but to help spread the Word that Jesus Christ is the Savior of the world,” said Glenn Hasse. “One way to do that is to encourage more people to go into the ministry. We are grateful to provide this gift for the library that will help to update the place where crucial preparation for ministry occurs.”



IN MEMORY OF KRISTINE KAY HASSE

The Hasses' support for the library is in memory of their daughter, Kristine, who died in an automobile accident at the age of 17, and is a testament to their deep love for the Seminary and its mission to prepare pastors, deaconesses and other church workers for future generations. Kristine, a star high school golfer, treasured her Lutheran upbringing. "It's just so extremely important to Glenn and me that we have pastors in our churches in the future, the kind we saw with our own children," said Kay Hasse. "That's our hope: to help more people to become ministers and church workers."

A LIBRARY FOR THE 21ST CENTURY!

“The myth is that books and libraries are going away. The truth is that libraries technologically equipped to reach people around the world will have a more profound impact than we could have imagined a few short decades ago. Our graduates will bring Jesus Christ to their congregations, communities and world. They will be served in this mission by the library, which will speed the best of theological resources to pastors and missionaries around the world.

“Concordia Seminary is immensely grateful to everyone for their support of the library renovation.”

Dr. Dale A. Meyer
Seminary President







Concordia
Seminary
ST. LOUIS

801 SEMINARY PLACE
ST. LOUIS, MO 63105
314-505-7000 • WWW.CSL.EDU

